

# 0.8 mm Connector

# 0.8 mm Adapter

# 0.8 mm Termination

DC - 145 GHz



Description	Page
Definitions . . . . .	2
Introduction . . . . .	3
0.8 mm Connector Features . . . . .	3
0.8–105F, 0.8–105M Connector Launchers . . . . .	3
0.8 mm In-Series Adapters . . . . .	3
0.8 mm Precision Terminations . . . . .	4
0.8 mm–W1 Adapters . . . . .	4
Specifications . . . . .	5
Notes . . . . .	7

## Definitions

	All specifications and characteristics apply under the following conditions, unless otherwise stated:
Typical Performance	Typical specifications that are not in parenthesis are not tested and not warranted. They are generally representative of characteristic performance. Typical specifications in parenthesis ( ) represent the mean value of measured units and do not include any guard-bands or uncertainties. They are not warranted.
Dimensions	All dimensions shown are in millimeters (mm) unless otherwise noted. All specifications subject to change without notice. For the most current data sheet, please visit the Anritsu web site: <a href="http://www.anritsu.com">www.anritsu.com</a>

## Introduction

The 0.8 mm Connector family is a complete coaxial connector system with single-mode performance to 145 GHz. It contains male and female non-hermetic connectors, male and female broadband terminations and in-series adapters. The 0.8 mm Connector is well suited for high frequency applications ranging from components to systems and instrumentation.

## 0.8 mm Connector Features

- Excellent RF Performance to 145 GHz
- 50  $\Omega$  Impedance
- Low VSWR
- Standard 0.8 mm Interface
- Accurate Testing Capability
- Broadband Load for Instrument and Device Under Test

## 0.8–105F, 0.8–105M Connector Launchers

The 0.8 mm connector launcher family includes both male and female screw-in type connectors. The 0.8 mm connector has an air dielectric front-side interface similar to K and V connectors. The center conductor is supported by Anritsu's proprietary low-loss high temperature support bead on one end, and a Teflon bead on the other end to provide exceptional concentricity and rigidity to the pin on the backside. The use of a high temperature support bead allows the connector to be subjected to extended temperature ranges up to 200 °C for a short period. The center conductor extends outside of the connector and allows the user to make a direct pin overlap connection to the microwave circuit.

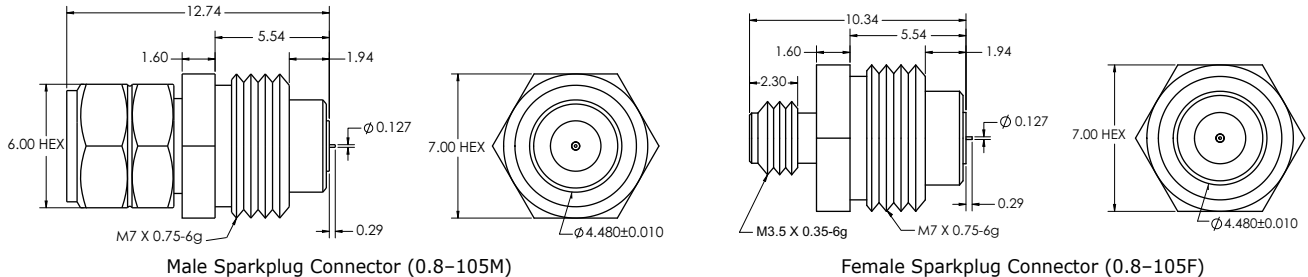

## 0.8 mm In-Series Adapters

The 33 series precision 0.8 mm Adapters enable accurate measurements with Anritsu 0.8 mm connectors at a broad frequency range of up to 145 GHz. The 33 series 0.8 mm – 0.8 mm adapters are available in three connector sex configurations: (male – male), (male – female), and (female – female). 0.8 mm adapters have an air dielectric interface and a center conductor that is supported by a proprietary low-loss high temperature support bead. When used as connector savers, these adapters protect the system's test port by reducing the number of connections made directly to the test port.

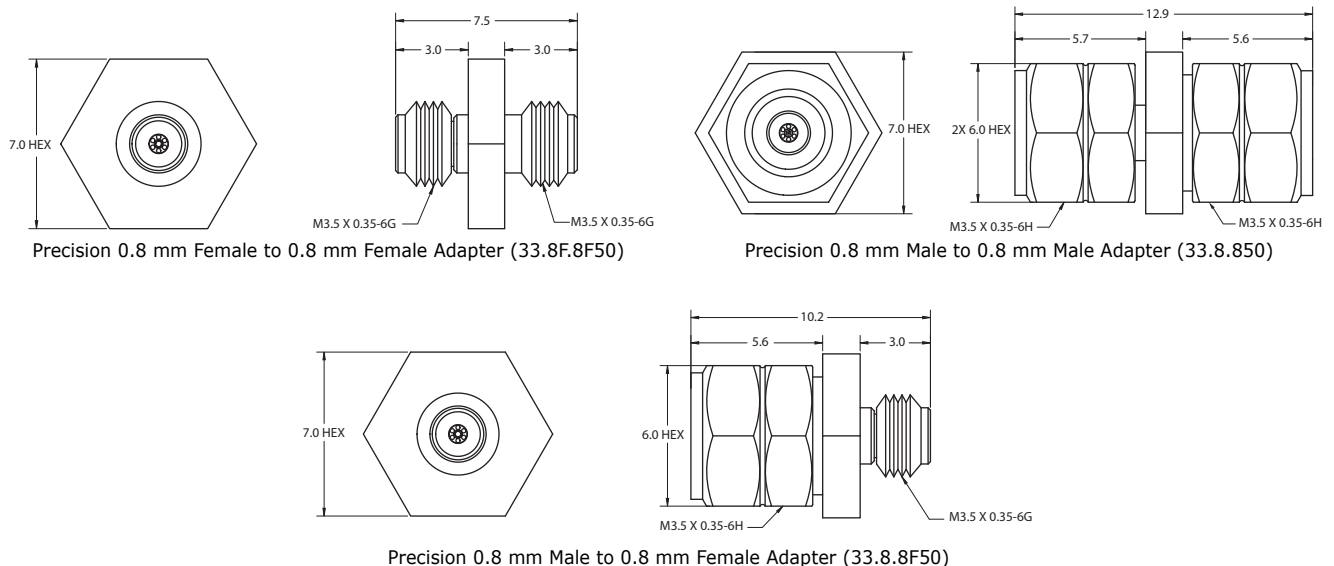

**0.8 mm Precision Terminations**

0.8 mm Precision Metrology-Grade Terminations are used in measurement systems that need to achieve the smallest possible reflections. Designed in both male and female configurations, these terminations can be used as a precision load for test instruments or devices under test.

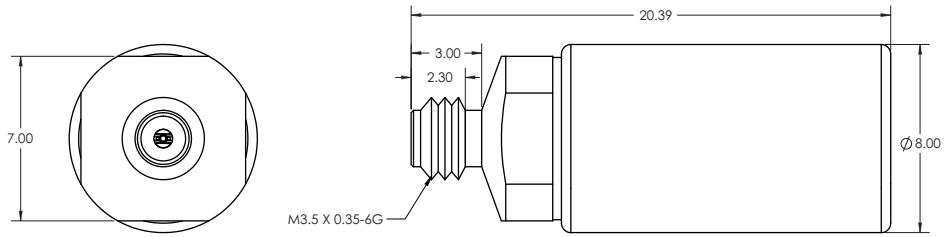

0.8 mm Female Precision Termination (28.8F50)

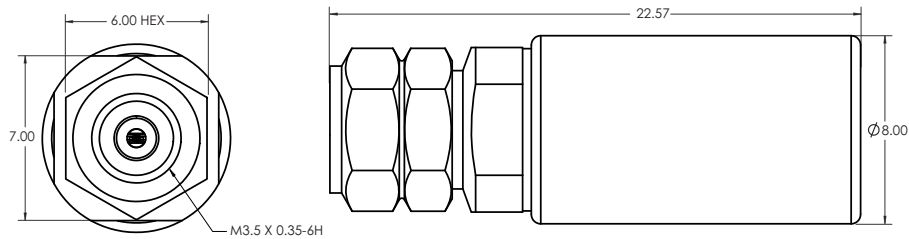

0.8 mm Male Precision Termination (28.850)

**0.8 mm-W1 Adapters**

0.8 mm - W1 adapters provide an interface between 0.8 mm connectors and W1 connectors and allow connections between two different connector types. Please contact Anritsu for more details on this product. [www.anritsu.com](http://www.anritsu.com)

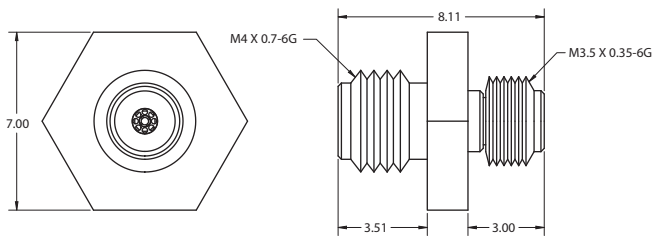

W1 Female to 0.8 mm Female Adapter (33WF.8F50)

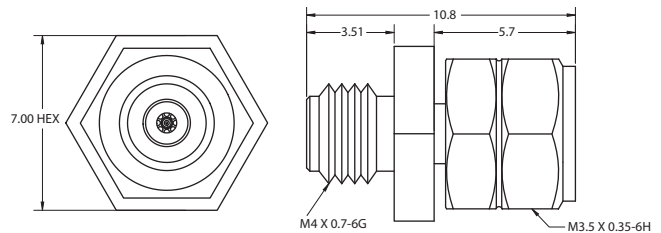

W1 Female to 0.8 mm Male Adapter (33WF.850)

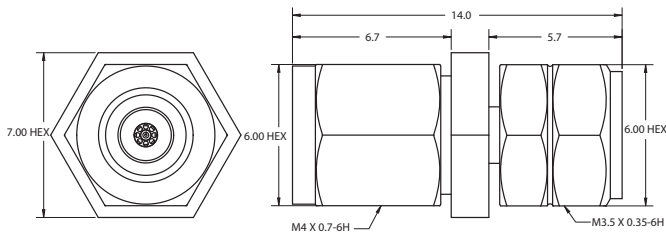

W1 Male to 0.8 mm Male Adapter (33W.850)

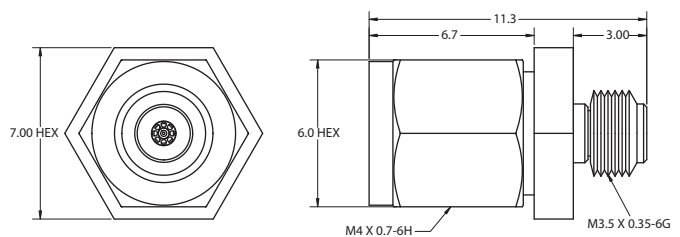

W1 Male to 0.8 mm Female Adapter (33W.8F50)

## Specifications

### 0.8 mm Precision Termination<sup>1,2</sup>

Model	Frequency Range	Test Port Connector	Input Impedance	VSWR	Dimensions Length x Diameter
28.850	DC to 145 GHz	0.8 mm	50 $\Omega$	< 1.052 to 40 GHz < 1.065 to 80 GHz < 1.222 to 145 GHz	2.3 x 8 cm
28.8F50	DC to 145 GHz	0.8 mm	50 $\Omega$	< 1.052 to 40 GHz < 1.065 to 80 GHz < 1.222 to 145 GHz	2.1 x 8 cm

### 0.8 mm and W1-0.8 mm Adapters<sup>1,2</sup>

Model	Connectors	Frequency	Insertion Loss (dB)	Return Loss (dB)
33.8.850	0.8 mm (male) to 0.8 mm (male)	DC to 145 GHz	0.6	> 23 dB to 40 GHz > 20 dB to 80 GHz > 18 dB to 110 GHz > 15 dB to 145 GHz
33.8.8F50	0.8 mm (male) to 0.8 mm (female)	DC to 145 GHz	0.6	> 23 dB to 40 GHz > 20 dB to 80 GHz > 18 dB to 110 GHz > 15 dB to 145 GHz
33.8F.8F50	0.8 mm (female) to 0.8 mm (female)	DC to 145 GHz	0.6	> 23 dB to 40 GHz > 20 dB to 80 GHz > 18 dB to 110 GHz > 15 dB to 145 GHz
33WF.8F50	W1 (female) to 0.8 mm (female) adapter	DC to 110 GHz	0.6	> 22 dB to 65 GHz > 18 dB to 80 GHz > 15 dB to 110 GHz
33WF.850	W1 (female) to 0.8 mm (male) adapter	DC to 110 GHz	0.6	> 22 dB to 65 GHz > 18 dB to 80 GHz > 15 dB to 110 GHz
33W.850	W1 (male) to 0.8 mm (male) adapter	DC to 110 GHz	0.6	> 22 dB to 65 GHz > 18 dB to 80 GHz > 15 dB to 110 GHz
33W.8F50	W1 (male) to 0.8 mm (female) adapter	DC to 110 GHz	0.6	> 22 dB to 65 GHz > 18 dB to 80 GHz > 15 dB to 110 GHz

### 0.8 mm Connector

Impedance	50 $\Omega$
Frequency	DC to 145 GHz
Insertion Loss	0.60 dB (typical)
Return Loss	15 dB to 145 GHz (typical)
Insulation Resistance	> 1200 M $\Omega$ typical
Center Conductor Contact Resistance	6 m $\Omega$ typical
Maximum Power	6 W
Front-side Pin Depth	0.0 to -0.076 mm
Backside Pin Protrusion	0.32 mm typical for 0.8-105F, 0.8-105M
Torque Coupling Nut	4 in-lb maximum

1. (Typical)

2. Maximum input power not to exceed 0.5 W

**List of 0.8 mm Connectors**

0.8-105F	0.8 mm (female) sparkplug connector
0.8-105M	0.8 mm (male) sparkplug connector
28.850	0.8 mm - male termination
28.8F50	0.8 mm - female termination
33.8.850	0.8 mm (male) to (male) adapter
33.8.8F50	0.8 mm (male) to (female) adapter
33.8F.8F50	0.8 mm (female) to (female) adapter

**List of W1 to 0.8 mm Connectors**

33WF.8F50	W1 (female) to 0.8 mm (female) adapter
33WF.850	W1 (female) to 0.8 mm (male) adapter
33W.850	W1 (male) to 0.8 mm (male) adapter
33W.8F50	W1 (male) to 0.8 mm (female) adapter

**Tools**

01-524	0.8 mm-6 mm Torque Wrench
01-525	6 mm x 7 mm Open End Wrench

**Environmental**

	Tests per MIL-STD-202F:
Temperature Shock	25 °C to -40 °C and 25 °C to +125 °C, method 107G, condition
Maximum Relative Humidity	95% at 40 °C, 96 hours, Test 103B, condition B, non operating only
Salt Spray	Spray 5% concentration for 48 hours, Method 101D, Condition B
Mechanical Shock	100G peak sawtooth, method 213, test condition 1
Vibration	Sine wave: 10 Hz to 2000 Hz, 0.06 in DA, method 204, test condition D Random: 50 Hz to 2000 Hz, 11.6 Grams, Power Spectral Density
Dielectric Withstanding Voltage	0.1 Grams <sup>2</sup> /Hz, Method 214, Test Condition I, Letter D 500 VAC RMS, 60 seconds, method 301

---

## Notes



Find Drivers, Utilities, Software Updates, and other Helpful Tools at the VectorStar Users Site. Visit:  
[www.anritsu.com/en-us/Products-Solutions/Solution/Welcome-to-the-VectorStar-Users-Site-.aspx](http://www.anritsu.com/en-us/Products-Solutions/Solution/Welcome-to-the-VectorStar-Users-Site-.aspx)

## Training at Anritsu

Anritsu has designed courses to help you stay up to date with technologies important to your job. For available training courses, visit: [www.anritsu.com/training](http://www.anritsu.com/training)



### • United States

#### **Anritsu Company**

1155 East Collins Blvd, Suite 100  
Richardson, TX 75081, U.S.A.  
Toll Free: 1-800-267-4878  
Phone: +1-972-644-1777  
Fax: +1-972-671-1877

### • Canada

#### **Anritsu Electronics Ltd.**

700 Silver Seven Road, Suite 120  
Kanata, Ontario K2V 1C3, Canada  
Phone: +1-613-591-2003  
Fax: +1-613-591-1006

### • Brazil

#### **Anritsu Eletrônica Ltda.**

Praça Amadeu Amaral, 27 - 1 Andar  
01327-010 Bela Vista, São Paulo, Brazil  
Phone: +55-11-3283-2511  
Fax: +55-11-3288-6940

### • Mexico

#### **Anritsu Company, S.A. de C.V.**

Av. Ejército Nacional No. 579 Piso 9, Col. Granada  
11520 México, D.F., México  
Phone: +52-55-1101-2370  
Fax: +52-55-5254-3147

### • United Kingdom

#### **Anritsu EMEA Ltd.**

200 Capability Green  
Luton, Bedfordshire LU1 3LU  
United Kingdom  
Phone: +44-1582-433280  
Fax: +44-1582-731303

### • France

#### **Anritsu S.A.**

12 Avenue du Québec  
Bâtiment Iris 1-Silic 612  
91140 Villebon-sur-Yvette, France  
Phone: +33-1-60-92-15-50  
Fax: +33-1-64-46-10-65

### • Germany

#### **Anritsu GmbH**

Nemetschek Haus, Konrad-Zuse-Platz 1  
81829 München, Germany  
Phone: +49-89-442308-0  
Fax: +49-89-442308-55

### • Italy

#### **Anritsu S.r.l.**

Via Elio Vittorini 129  
00144 Roma, Italy  
Phone: +39-06-509-9711  
Fax: +39-06-502-2425

### • Sweden

#### **Anritsu AB**

Kistagången 20B  
164 40 KISTA, Sweden  
Phone: +46-8-534-707-00  
Fax: +46-8-534-707-30

### • Finland

#### **Anritsu AB**

Teknobulevardi 3-5  
FI-01530 Vantaa, Finland  
Phone: +358-20-741-8100  
Fax: +358-20-741-8111

### • Denmark

#### **Anritsu A/S**

Kay Fiskers Plads 9  
2300 Copenhagen S, Denmark  
Phone: +45-7211-2200  
Fax: +45-7211-2210

### • Russia

#### **Anritsu EMEA Ltd.**

**Representation Office in Russia**  
Tverskaya str. 16/2, bld. 1, 7th floor  
Russia, 125009, Moscow  
Phone: +7-495-363-1694  
Fax: +7-495-935-8962

### • United Arab Emirates

#### **Anritsu EMEA Ltd.**

##### **Dubai Liaison Office**

P O Box 500413 - Dubai Internet City  
Dubai, United Arab Emirates  
Phone: +971-4-3670352  
Fax: +971-4-3688460

### • Singapore

#### **Anritsu Pte. Ltd.**

11 Chang Charn Road, #04-01, Shriro House  
Singapore 159640  
Phone: +65-6282-2400  
Fax: +65-6282-2533

### • India

#### **Anritsu India Private Limited**

2nd & 3rd Floor, #837/1, Binnamangla 1st Stage  
Indiranagar, 100ft Road, Bangalore - 560038, India  
Phone: +91-80-4058-1300  
Fax: +91-80-4058-1301

### • P.R. China (Shanghai)

#### **Anritsu (China) Co., Ltd.**

27th Floor, Tower A  
New Caohejing International Business Center  
No. 391 Gui Ping Road Shanghai, Xu Hui Di District  
Shanghai 200233, P.R. China  
Phone: +86-21-6237-0898  
Fax: +86-21-6237-0899

### • P.R. China (Hong Kong)

#### **Anritsu Company Ltd.**

Unit 1006-7, 10/F., Greenfield Tower  
Concordia Plaza  
No. 1 Science Museum Road, Tsim Sha Tsui East  
Kowloon, Hong Kong, P. R. China  
Phone: +852-2301-4980  
Fax: +852-2301-3545

### • Japan

#### **Anritsu Corporation**

8-5, Tamura-cho, Atsugi-shi  
Kanagawa, 243-0016 Japan  
Phone: +81-46-296-1221  
Fax: +81-46-296-1238

### • Korea

#### **Anritsu Corporation, Ltd.**

5FL, 235 Pangyoyeok-ro, Bundang-gu  
Seongnam-si  
Gyeonggi-do, 463-400 Korea  
Phone: +82-31-696-7750  
Fax: +82-31-696-7751

### • Australia

#### **Anritsu Pty Ltd.**

Unit 21/270 Ferntree Gully Road  
Notting Hill, Victoria, 3168, Australia  
Phone: +61-3-9558-8177  
Fax: +61-3-9558-8255

### • Taiwan

#### **Anritsu Company Inc.**

7F, No. 316, Sec. 1, Neihu Rd, Taipei 114, Taiwan  
Phone: +886-2-8751-1816  
Fax: +886-2-8751-1817

List Revision Date: 20141016



© Anritsu All trademarks are registered trademarks of their respective companies. Data subject to change without notice. For the most recent specifications, visit: [www.anritsu.com](http://www.anritsu.com). Anritsu utilizes recycled paper and environmentally conscious inks and toner.

0.8 mm Connectors TDS  
Copyright May 2015 Anritsu Company, USA  
All Rights Reserved



11410-00317



A